

# London Borough of Sutton - Pavement Licence Application

Case Reference LBS PLA739870374

Applicant Name: J D WETHERSPOON PLC

Business Name: Nonsuch Inn

Case Created: 13/08/2025 13:38



## Applicants Details

Customer or Company Name	J D WETHERSPOON PLC
Date of Birth	
Address	Wetherspoon House, Reeds Crescent, Watford, Hertfordshire, WD24 4QL
Email Address	
Contact Number	

## Business Details

Name	Nonsuch Inn
Address	552-556 LONDON ROAD, NORTH CHEAM, SUTTON SM3 9AA
Email Address	
Contact Number	
Business Type	Public House, wine bar or other drinking establishment

## Location

Description	Public footway to the front of the premises, either side of the entrance doors, on London Road	
Relevant Purpose	For the purpose of consuming food or drink	
<b>Proposed Days / Hours</b>	<b>From</b>	<b>To</b>
Monday	08:00	21:00
Tuesday	08:00	21:00
Wednesday	08:00	21:00
Thursday	08:00	21:00
Friday	08:00	21:00
Saturday	08:00	21:00
Sunday	08:00	21:00
Furniture Description	6 mill top flip tables 0 7m x 0 7m 20 tempered resin galaxy chairs 0.4m x 0.4m. freestanding post and banner barriers	

NOTE - Responsibility is not accepted for errors made by others in scaling from this drawing. All construction information should be taken from figured dimensions only

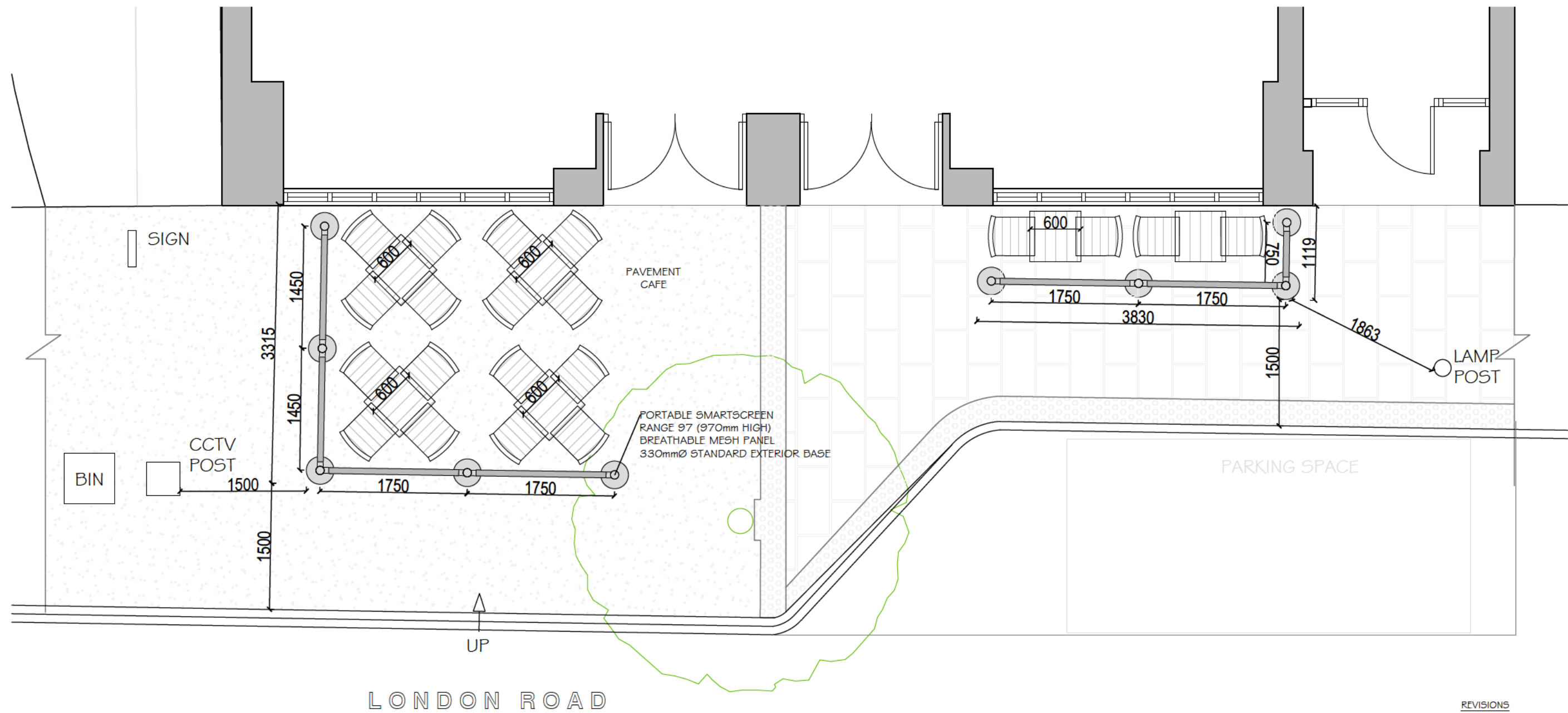

REVISIONS

-

kdp

Brooklyn Chambers, 11 Goring Road,  
Worthing, West Sussex BN12 4AP  
+44 (0)1903 496 999 www.kdpaine.co.uk

CLIENT	JD WETHERSPOON PLC	
PROJECT	PUB NO: 154 NONSUCH INN CHEAM	
DRAWING	PROPOSED PAVEMENT CAFE	

SCALE	DATE	DRAWN
A3/1:50	JUL 2025	AKS
PROJECT No	DRAWING No	REVISION
5009	101	